

JR. MEDIUM, 20 KG ROASTING BOX

ASSEMBLING INSTRUCTIONS

PARTS

Qty.	Item	Description
14		1/4-20 x 1/2" Bolt
18		1/4-20 x 1" Bolt
2		1/4 -20 x 2" Eye Bolt/Nut
18		1/4 -20 Nut
1		Syringe and Needle set
4		S-Hooks
2	T	Cap Nut 3/8"
1	S	Round Bar 3/8"
2	W	Wheels 5" x 1" x 3/8"
2	V	Short Handles for Drip Tray Large
4	U	Handles for Ash Tray and Charcoal Screen
2	A	Short End Panels 17,5"
1	B	Bottom Alum Enclosure 17,5" x 35"
1	C	Bottom Wood Panel 17,5" x 35"
2	D	Long Side Panels 36"
2	E	Metal Legs 22" (Wheels Side)
2	F	Metal Legs 24"
2	G	Bottom Bracket support 16"
2	H	Bottom Bracket support 10"
2	I	Long Top Rails 36"
2	J	Short Top Rails 17,5"
1	K	Drip Tray
2	L	Metal Grills
1	M	Ash Tray Lid
1	N	Charcoal Screen
1	O	Tray Wire Rack
1	P	Box Handle
2	Q	Mounting Brackets
2	R	Footers

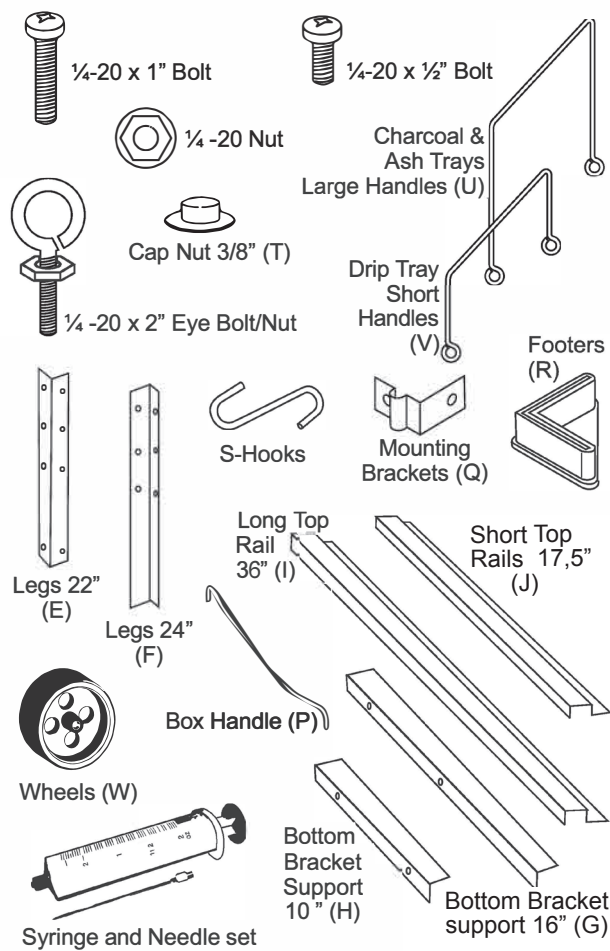

TOOLS NEEDED

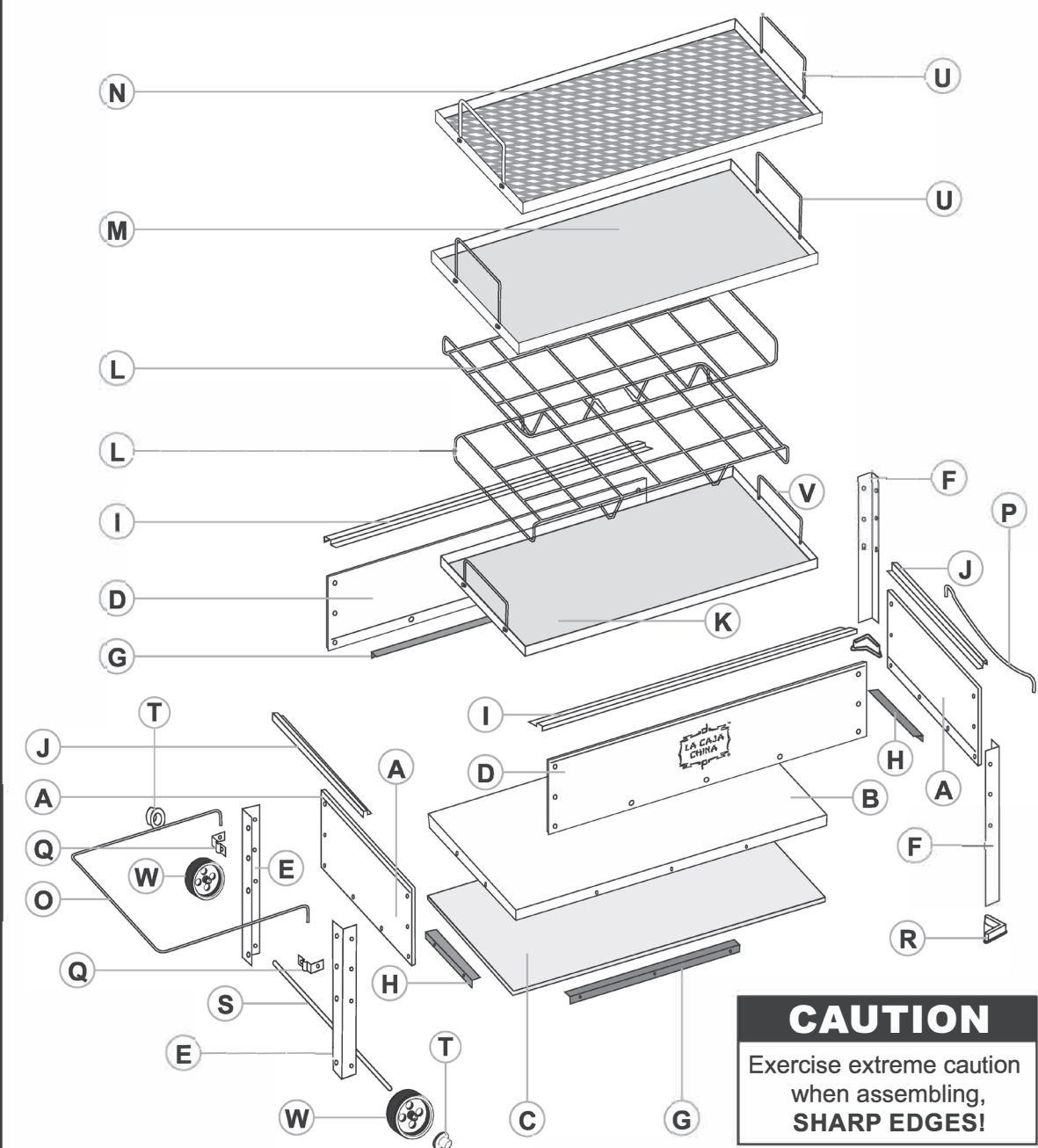
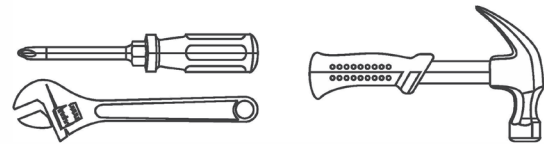

CAUTION

Exercise extreme caution when assembling, SHARP EDGES!

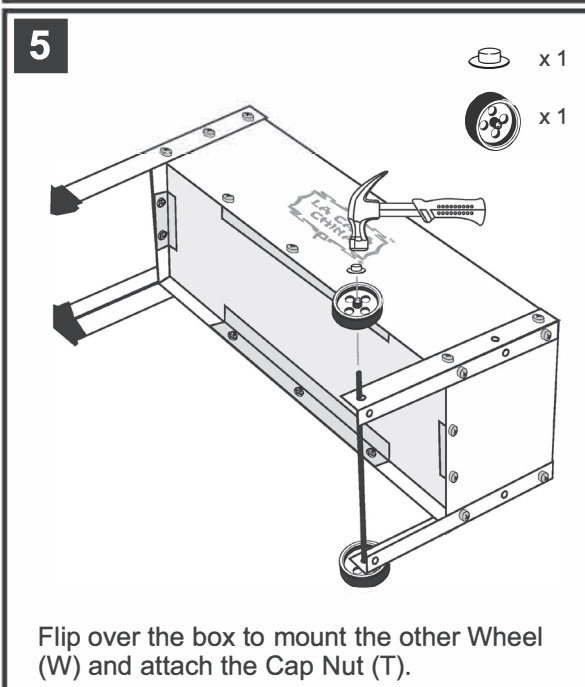
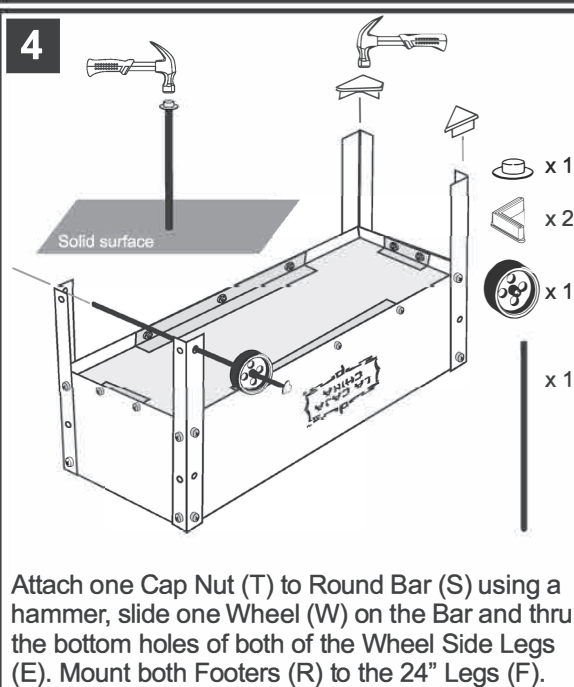
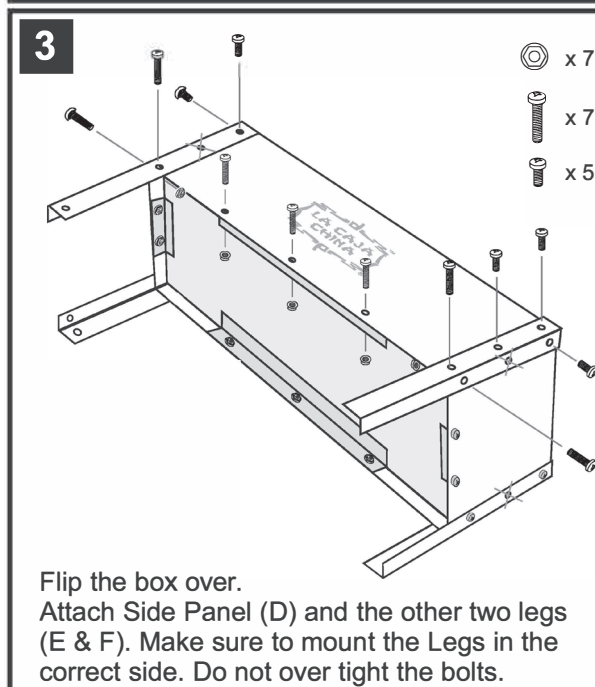
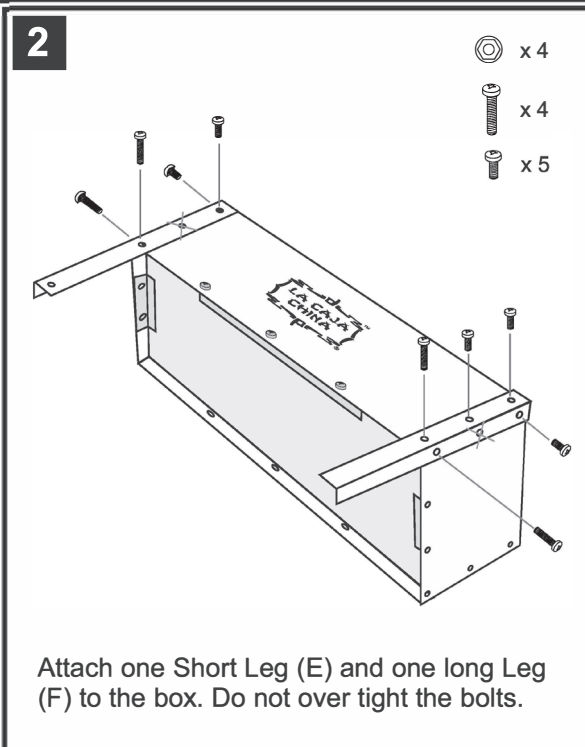
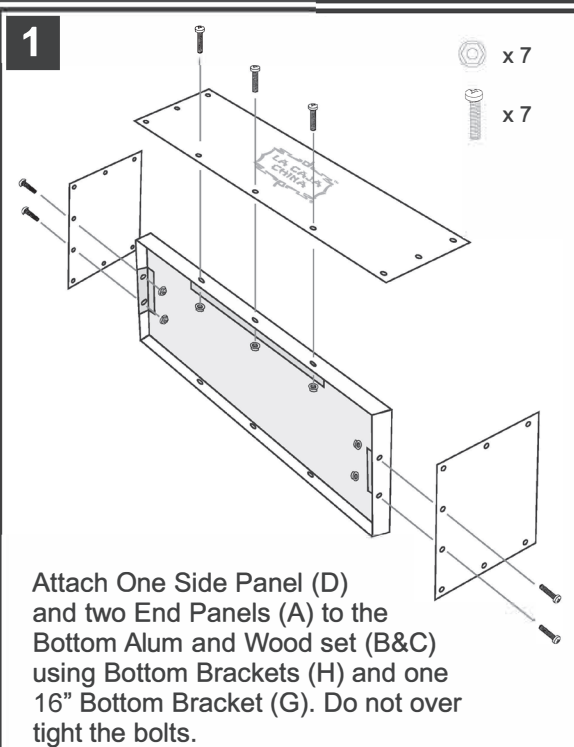

6

⌘ x 4
⌘ x 2

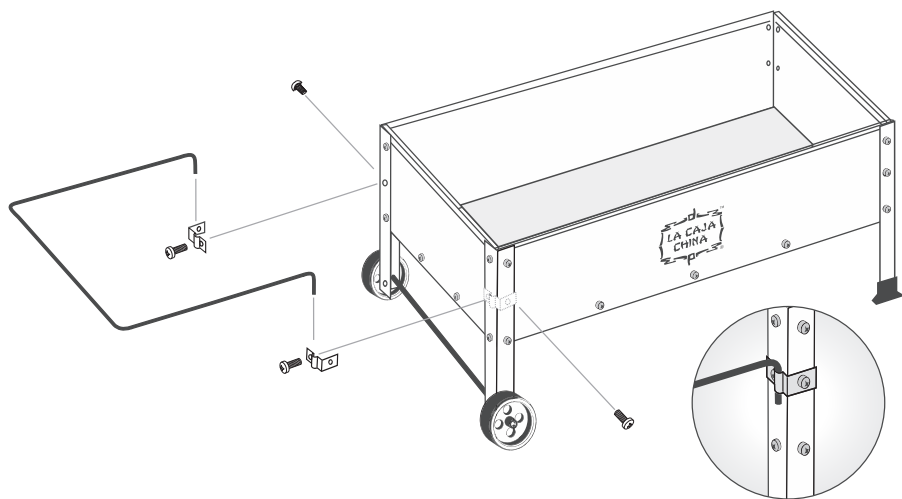

Attach the two Mounting Brackets (Q) to the Wheel Side Legs (E). Slide Tray Wire Rack (O) into both brackets.

7

⌘ x 2

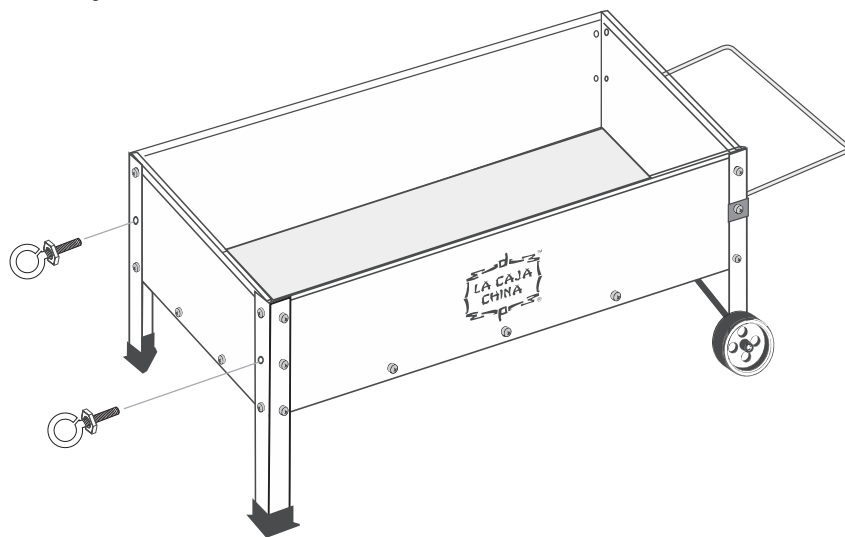

Attach the two Eye Bolts/Nut to the 24" Legs (F). Tighten all bolts and nuts at this time.

8

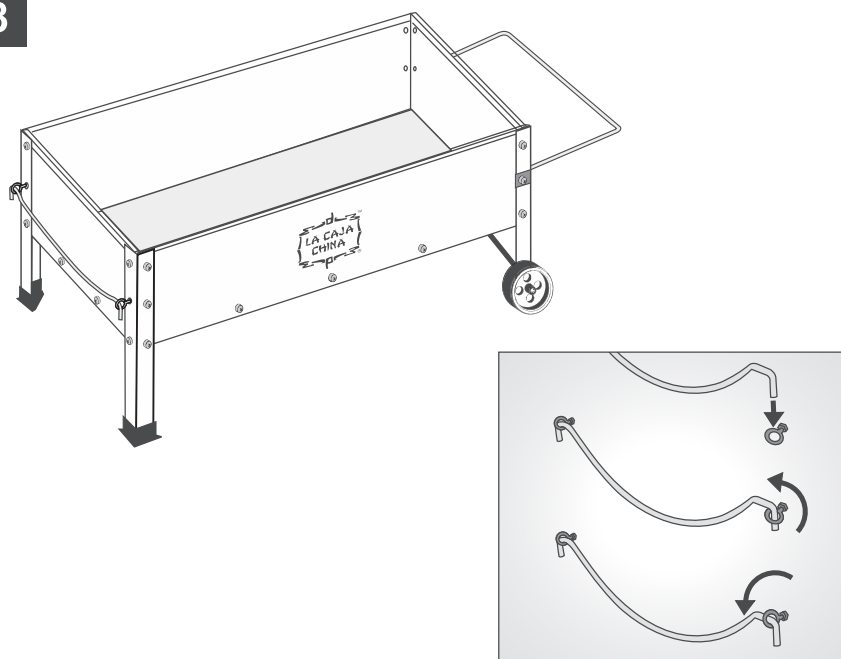

Attach Box Handle (P) to the two Eye Bolts/Nut (see detail).

9

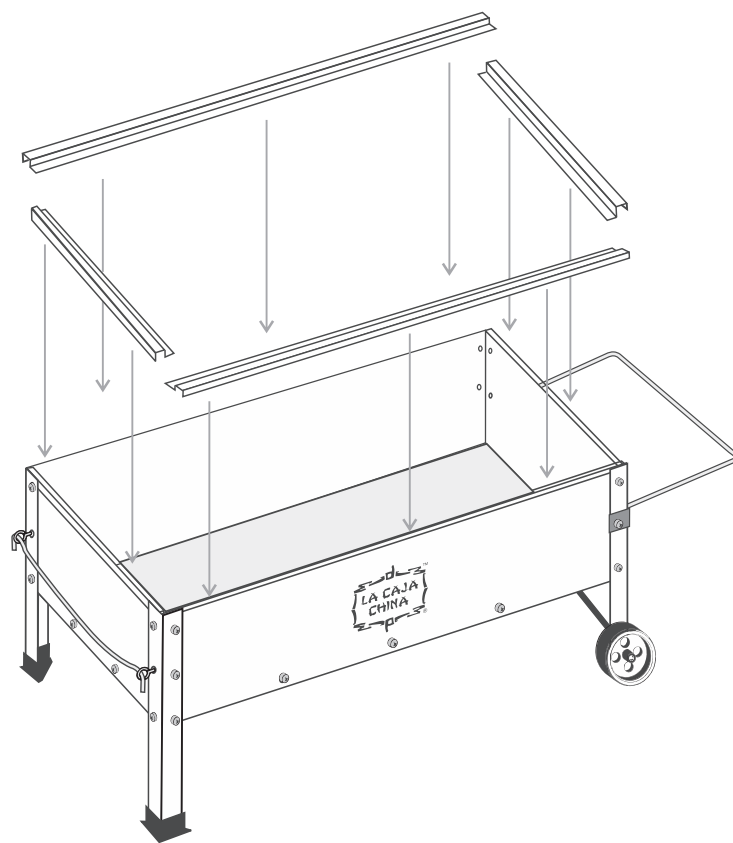

Mount the two Long Side Rails (I) first and then the two Short Top Rails (J).

STACKING ORDER

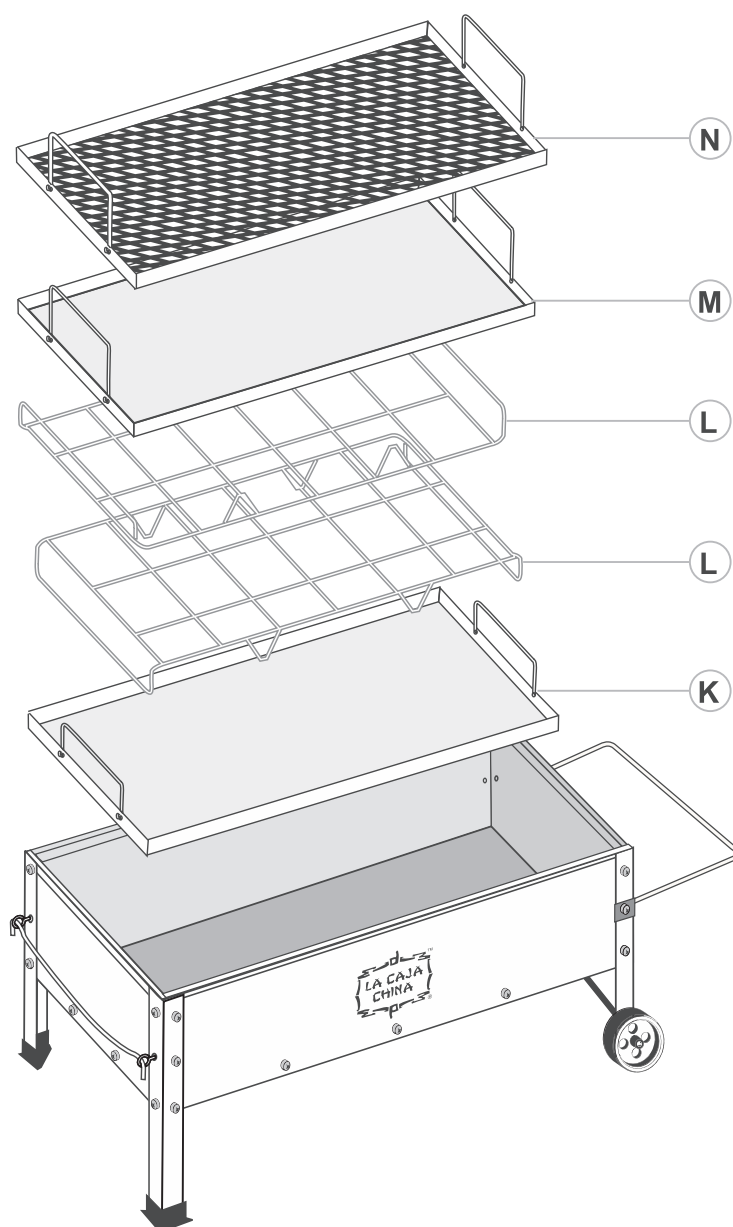

10

⌘ x 2 ⌘ x 4

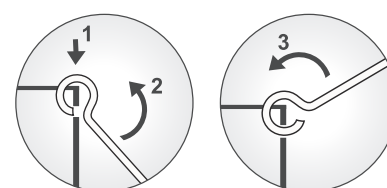

Attach 2 Short Handles (V) to Drip Tray (K), attach 2 handles (U) to Charcoal Screen (N), and attach 2 handles (U) to Ash Tray Lid (M).



CAUTION

Exercise extreme caution when assembling, **SHARP EDGES!**

If you have any questions regarding the assembly of this product, please call **+386 40 197 008**
Monday-Friday 8:00 a.m - 5:00 p.m.

www.lacajachina.eu